



# NOTICE SOMETHING DIFFERENT? CHECK IT OUT...

## NEW Floor Plate Diagram

**Instructions:** Place the reserve closing loop through AAD cutter according to diagram.



*Improper Closing Loop Routing*

PLEASE PAY  
SPECIAL  
ATTENTION TO  
DIAGRAM ON  
FLOOR PLATE

(Shown Right)

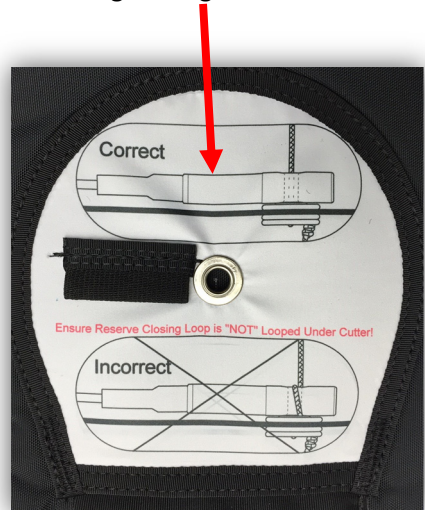

*New Floor Plate with Diagram*

## Collins Lanyard Location



*NEW Collins Lanyard Location*

Collins Lanyard is  
now located in  
front of right side  
yoke under the  
RSL channel



*NEW Collins Lanyard Location*